

DHI-HY-L131

LoRa Smoke Detector



- EMC-tested: Ensured strong anti-electromagnetic interference, high stability, and reliability
- Dual photoelectric smoke sensing chamber for intelligent and precise smoke detection
- BLC algorithm: auto-adjusts alarm threshold, extends cleaning cycle, easier maintenance
- Swift audible and visual alarm signaling
- High acid and rust resistance of contact material

System Overview

The DHI-HY-L131 LoRa Smoke Detector is compatible with Addressable Fire Alarm Control Panels and can easily connect to them. It uses LoRa networking technology to transmit information wirelessly. This detector is equipped with a dual photoelectric smoke sensing chamber, which enables it to accurately analyze the concentration of ambient smoke.

Functions

Smoke detection

Integrated with dual photoelectric smoke sensing chamber, it identifies smoke effectively and provides higher fire detection accuracy.

Dual photoelectric smoke sensing chamber

The smart algorithm of automatic compensation against dust concentration helps adjust alarm threshold, prolong cleaning cycle of chamber, and offering a convenient maintenance.

Wireless communication

Without wiring, easy installation.

Scene

It is suitable for apartments, hotels, teaching buildings, office buildings, banks, libraries, warehouses, computer rooms, communication machine rooms, archives, and other industrial and civil buildings.

Technical Specification

Communication	LoRa
Communication Distance	Free space: a maximum of 1500 metres Ordinary walls: 3-5
Alarm Mode	Visual and audible alarm
Alarm Type	Smoke alarm, low battery warning, tamper alarm
Alarm Volume	Over 80 dB (A) at 3 m (9.84 ft)
Alarm Output	RF transmission
Manual Control	Manual alarm, manual silence, manual reset
Silence Duration	≤ 100 s
Operating Voltage	DC3V
Operating Current	Monitoring Current: ≤15uA Alarm Current: ≤35mA
LED Instruction	Alarm: Red indicator flashes once every second Fault: Red indicator flashes once every minute Standby: Green indicator flashes once every minute
Battery Life	About 3 years
Battery	DC3V, 1400mAh
Coverage Area	H ≤ 4 m (13.12 ft): 150 m ² 4 m(13.12 ft) ≤ H ≤ 12 m(39.37 ft): 80 m ²
Operating Temperature	-10°C to +55°C (+14°F to +131°F)
Storage Temperature	-20°C to +60°C (-4°F to +140°F)
Operating Humidity	≤ 95% RH (no condensation)
Dimensions (with base)	Φ117 mm × 53 mm (Φ 4.61" × 2.09")
Weight (with battery)	182 g (0.40 lb)
Installation	Ceiling Mount
Color	White

Installation

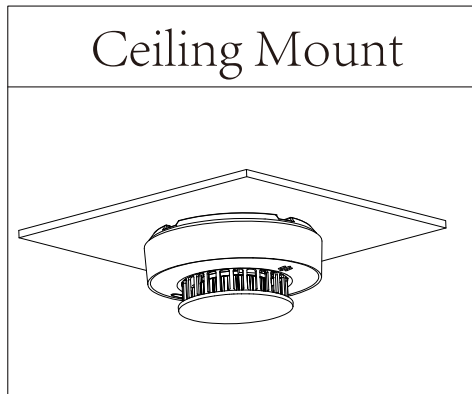

Dimensions (mm/inch)

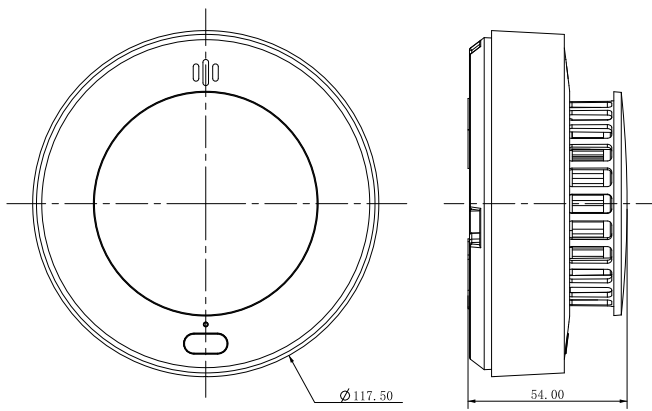

Ordering Information

Type	Model	Description
LoRa Smoke Detector	DHI-HY-L131	LoRa Smoke Detector